

GE..AW - stål/PTFE-väv

GE..AW - teräs/PTFE-kudos

GE..AW - steel/PTFE-fabric

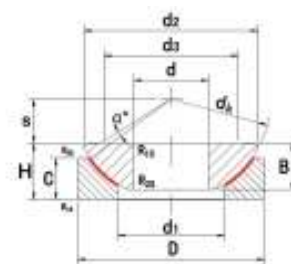

Underhållsfritt axialledlager med inner- och ytterring av stål. Innerringens glytja är hårdförokromad, ytterringens glidskikt är en PTFE-väv.

Huoltovapaa aksiaalinvellaakeri. Sisärenkaan liukupinta on kovakromattu, ulkorenkaan liukupinta PTFE-kudosta.

Maintenance-free axial spherical plain bearing with inner- and outer ring of steel. The slide surface of the inner ring is hard chrome plated. The outer ring has a sliding layer of PTFE-fabric.

Benämning/Nimitys/Type	Dimensions mm										Load ratings kN				
	d	D	H	d_k	d_1	d_2	d_3	B	C	S	R_{1S} min	R_{2S} min	α	dyn C	stat. C_0
GE 10 AW	10	30	9.5	32	16.5	27.5	21	7.9	6.0	7.0	0.6	0.2	10	36	72
GE 12 AW	12	35	13	37	19.5	32	24	9.3	9.0	8.0	0.6	0.2	9.0	49	98
GE 15 AW	15	42	15	45	24	38.9	29	10.7	11	10	0.6	0.2	7.0	78	156
GE 17 AW	17	47	16	50	28	43.4	34	11.5	11.5	11	0.6	0.2	6.0	88	176
GE 20 AW	20	55	20	60	33.5	50	40	14.3	13	12.5	1.0	0.3	6.0	112	224
GE 25 AW	25	62	22.5	66	34.5	57.5	45	16	17	14.0	1.0	0.3	7.0	193	390
GE 30 AW	30	75	26	80	44	69	56	18	19.5	17.5	1.0	0.3	6.0	225	510
GE 35 AW	35	90	28	98	52	84	66	22	20	22	1.0	0.3	6.0	390	780
GE 40 AW	40	105	32	114	59	98	78	27	22	24.5	1.0	0.3	6.0	560	1120
GE 45 AW	45	120	36.5	130	68	112	89	31	25	27.5	1.0	0.3	6.0	735	1460
GE 50 AW	50	130	42.5	140	69	122.5	98	33.5	32	30	1.0	0.3	5.0	980	1960
GE 60 AW	60	150	45	160	86	140	108	37	33	35	1.0	0.3	7.0	1100	2200
GE 70 AW	70	160	50	170	95	149.5	121	40	36	35	1.0	0.3	6.0	1200	2400
GE 80 AW	80	180	50	194	108	168	130	42	36	42.5	1.0	0.3	6.0	1560	3100
GE 100 AW	100	210	59	220	133	195.5	155	50	42	45	1.0	0.3	7.0	1800	3600
GE 120 AW	120	230	64	245	154	214	170	52	45	52.5	1.0	0.3	8.0	1860	3750
GE 140 AW	140	260	72	272	176	244	198	61	50	52.5	1.5	0.6	6.0	2450	4900
GE 160 AW	160	290	77	310	199	272	213	65	52	65	1.5	0.6	7.0	2850	5700
GE 180 AW	180	320	86	335	224	300	240	70	60	67.5	1.5	0.6	8.0	3200	6400
GE 200 AW	200	340	87	358	246	321	265	74	60	70	1.5	0.6	8.0	3550	7100
GE 220 AW	220	370	97	388	265	350	289	82	67	75	1.5	0.6	7.0	4400	8800
GE 240 AW	240	400	103	420	294	382	314	87	73	77.5	1.5	0.6	6.0	5200	10400
GE 260 AW	260	430	115	449	317	409	336	95	80	82.5	1.5	0.6	7.0	5400	10800
GE 280 AW	280	460	110	480	337	445	366	100	85	80	3.0	1.0	4.0	8500	17000
GE 300 AW	300	480	110	490	356	460	388	100	90	80	3.0	1.0	3.5	8650	17300
GE 320 AW	320	520	116	540	380	500	405	105	91	95	4.0	1.1	4.0	10600	21200
GE 340 AW	340	540	116	550	380	510	432	105	91	95	4.0	1.1	4.0	11800	23600
GE 360 AW	360	560	125	575	400	535	452	115	95	95	4.0	1.1	4.0	12700	25500